

TECHNONICOL SHINGLAS Cutting pattern

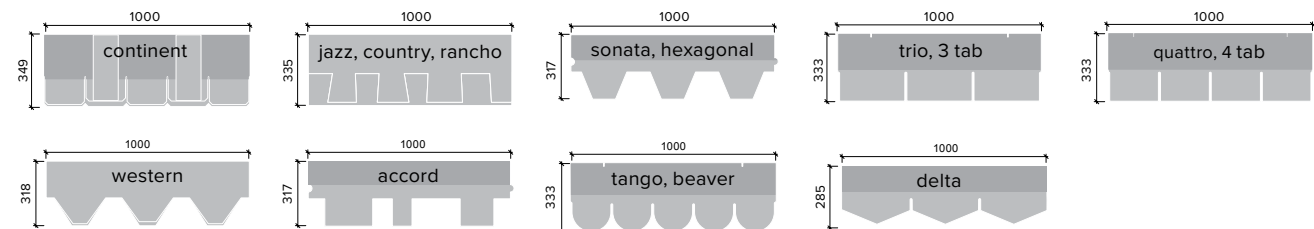

Systems

TN-SHINGLAS Classic

The system is designed for the creation of a cold attic on pitched roofs of any complexity and configuration. SHINGLAS roofing shingles are used as a roof covering.

SYSTEM COMPONENTS:

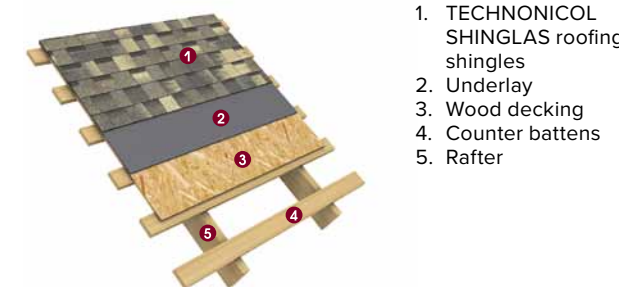

1. TECHNICONIC SHINGLAS roofing shingles
2. Underlay
3. Wood decking
4. Counter battens
5. Rafter

TN-SHINGLAS Attic

The system is successfully used for the creation of an attic floor in low-rise buildings and cottages. SHINGLAS roofing shingles are used as a roof covering.

SYSTEM COMPONENTS:

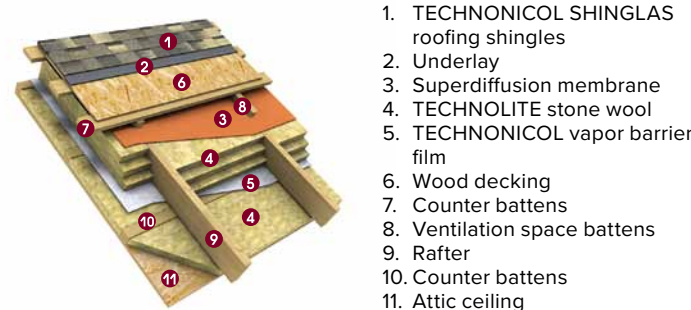

1. TECHNICONIC SHINGLAS roofing shingles
2. Underlay
3. Superdiffusion membrane
4. TECHNOLITE stone wool
5. TECHNICONIC vapor barrier film
6. Wood decking
7. Counter battens
8. Ventilation space battens
9. Rafter
10. Counter battens
11. Attic ceiling

Valley roll materials and underlayment



MIDA SELF

UNDERLAY PRO 500



Physical and mechanical properties

| Properties | Hip and ridge shingles | Valley roofing material MIDA UNIFLEKS EKM | MIDA SELF PV S2,0s | UNDERLAY PRO 500 stick |
|--|------------------------|---|--------------------|------------------------|
| Manufacturing standard | EN 544 | EN 13707 | EN 13707 | EN 13859-1 |
| Type of polymer/modifier | SBS | SBS | SBS | SBS |
| Package of finished roofing, m ² | 5 | 10 | 15 | 25 |
| Package weight, kg | 25 | 46 | 43,5 | 12,5 |
| Weight of 1 m ² of finished covering, kg/m ² | 5 | 4,6 | 2,9 | 0,5 |

Quality management system certified to ISO 9001:2015



Roof arrangement schematic

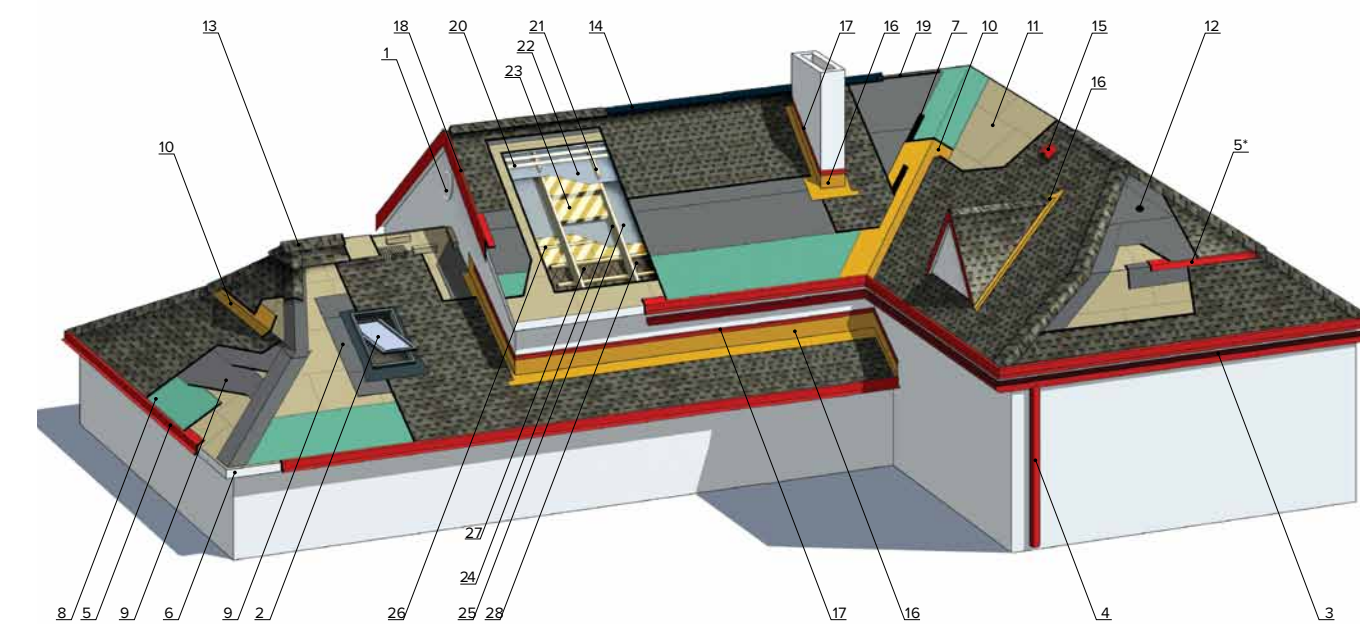

1. Gable End
2. Skylight pivot window
3. Gutter
4. Downpipe
5. Eave support
6. Fascia board
7. Bitumen adhesive compound
8. Self-adhesive membrane
9. Underlayment
10. Valley roll material
11. Plywood close boarding
12. Boiler flue or soil vent hole
13. Ventilated ridge
14. Ridge ventilation
15. Roof vent
16. Cover flashing
17. Flashing
18. Dry verge profile
19. Air gap at ridge top point
20. Thin batten
21. Counter batten
22. Superdiffusion membrane
23. Thermal insulation
24. Trusses or rafters
25. Vapor barrier
26. Counter insulation
27. Metal wire d=2 mm, pitch 250 mm, or special screen
28. Two layers of gypsum plasterboard

TECHNONICOL SHINGLAS structure

Upside surfacing: basalt
 Bitumen: improved
 Base: glass fibre
 Bitumen: improved
 Underside surfacing: self-adhesive polymer modified bitumen compound
 Protective layer: easily removable siliconized film

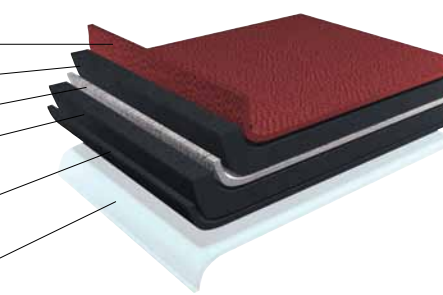

Physical and mechanical properties

| Properties | Continent | Western | Jazz | Country | Rancho | Ultra | Classic | Standard | Standard Rock |
|--|-----------|---------|--------|---------|--------|--------|------------|-------------|---------------|
| Manufacturing standard | EN 544 | EN 544 | EN 544 | EN 544 | EN 544 | EN 544 | EN 544 | ETA 09/0280 | ETA 12/0264 |
| Type of polymer/modifier | — | — | — | — | — | SBS | — | — | — |
| Package of finished roofing, m ² | 1,5 | 1,5 | 2 | 2,6 | 2 | 3 | 3 | 3 | 3 |
| Package weight, kg | 38,1 | 26,4 | 27 | 32,5 | 25 | 28,5 | 27,0–33,0* | 25,5–31,5* | 24,0–30,0* |
| Weight of 1 m ² of finished covering**, kg/m ² | 25,4 | 17,6 | 13,5 | 12,5 | 12,5 | 9,5 | 9,0–11,0 | 8,5–10,5 | 8,0–10,0 |

* depends on the shape of cuts (sonata, accord, trio, tango, delta)

** weight of 1 m² of roof covering for roof load capacity calculation; depends on the shape of cuts (sonata, accord, trio, tango, delta)

For more information visit shinglas.com



Issue Date 2017-01

ROOFING SHINGLES

COLLECTION OF COLORS

Download ITN SHINGLAS app for iOS and Android
 AppStore I-SHINGLAS
 Google Play ITN SHINGLAS

KNOWLEDGE. EXPERIENCE. CRAFTSMANSHIP.

WWW.TN-EUROPE.COM

TECHNONICOL SHINGLAS multilayer roofing shingles

CONTINENT collection EN 544



Triple-layer roofing shingles are an elite material. They resemble antique stone roofing tiles and create an incredible ultra-dimensional look.

60 YEARS
MANUFACTURER'S WARRANTY

WESTERN collection EN 544

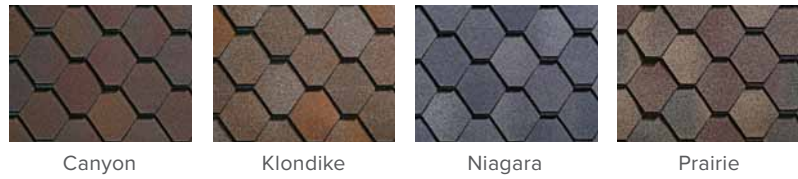

The patent design of this double layer roofing shingles has no analogs in the world. It's an incredible holographic effect embodied in classic pattern. The WESTERN collection is an inimitable range of colors and excellent performance.

55 YEARS
MANUFACTURER'S WARRANTY

JAZZ collection EN 544



An exquisite color palette, an intricate play of hues and a dramatic 3D profile. A special pattern creates an appealing look of natural handmade tiles like slate or wooden shakes. These double-layer roofing shingles have an increased thickness and stand out for their enhanced endurance and wind resistance.

50 YEARS
MANUFACTURER'S WARRANTY

COUNTRY collection EN 544



The COUNTRY collection of double-layer roofing shingles comprises nine incredible color solutions that imitate diverse nature's shades and nuances. Vibrant color blends and expressive shadow lines create a wonderful dimensional visual image.

50 YEARS
MANUFACTURER'S WARRANTY

RANCHO collection EN 544



Desirable double-layer roofing shingles everybody can afford! Three popular colors will match any architectural style and provide an elegant and respectable look to your house.

30 YEARS
MANUFACTURER'S WARRANTY

TECHNONICOL ROOFING SHINGLES

ULTRA series EN 544

ULTRA is the only series made with SBS-modified asphalt that gives exceptional physical and mechanical properties to the product and improves its frost resistance. Due to its enhanced flexibility ULTRA is also the best choice for the most complex construction design.

50 YEARS
MANUFACTURER'S WARRANTY



CLASSIC series EN 544

CLASSIC is a time tested traditional product that stays popular due to its reasonable price-quality ratio. Coming in various color hues CLASSIC shingles allow to choose roofing that complements any architectural design. It has the benefit of containing a high-quality asphalt binder.

30 YEARS
MANUFACTURER'S WARRANTY

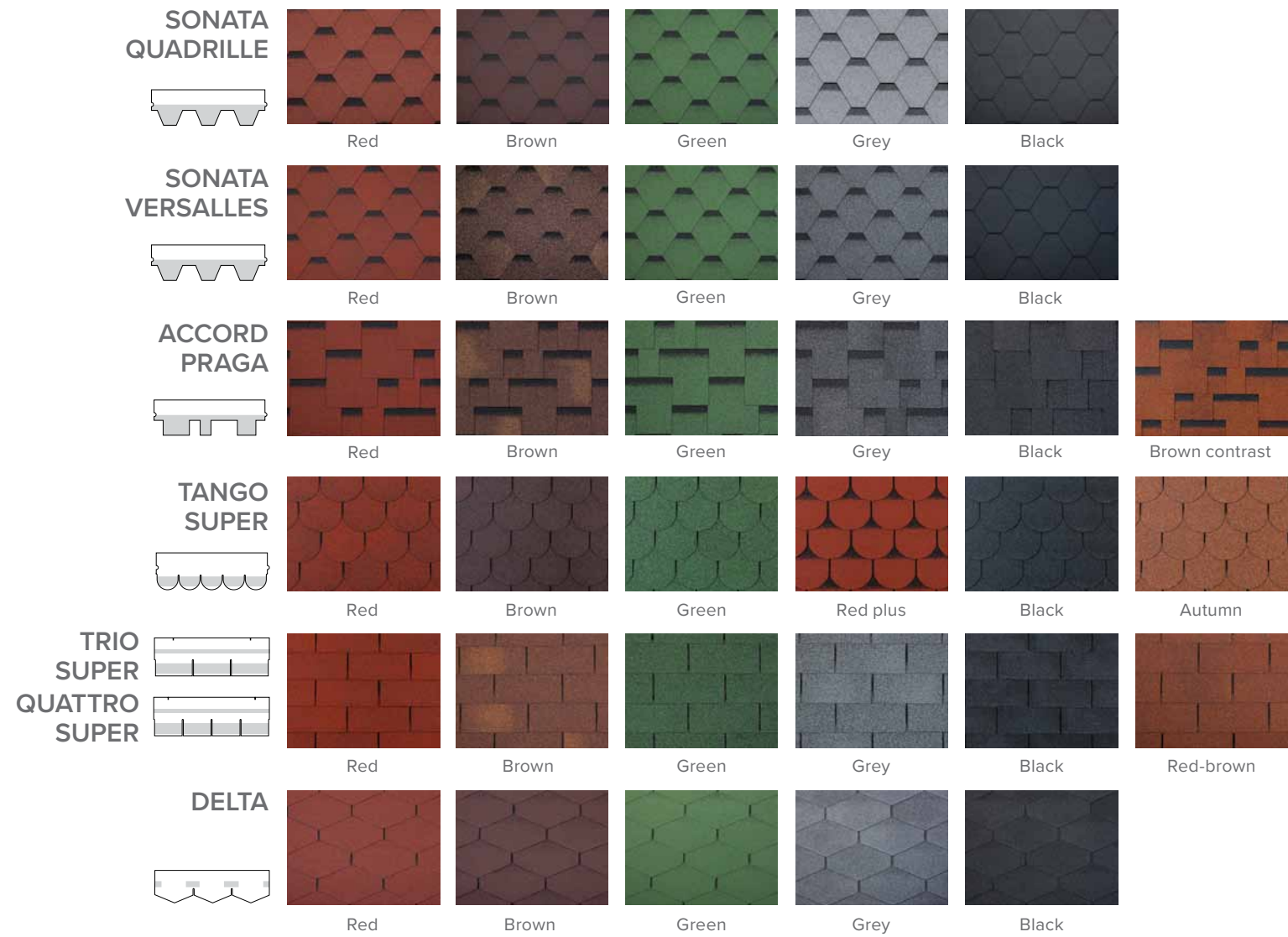

NOTE: Actual product colors may vary slightly from the colors shown in the catalogue. If color hue is critical for you, please request full-size samples before making your final choice.

TECHNONICOL ROOFING SHINGLES

STANDARD series ETA 09/0280

STANDARD series shingles are available in lots of shapes and colors. Created for people who want to feel confident they're getting the best price.

10 YEARS
MANUFACTURER'S WARRANTY

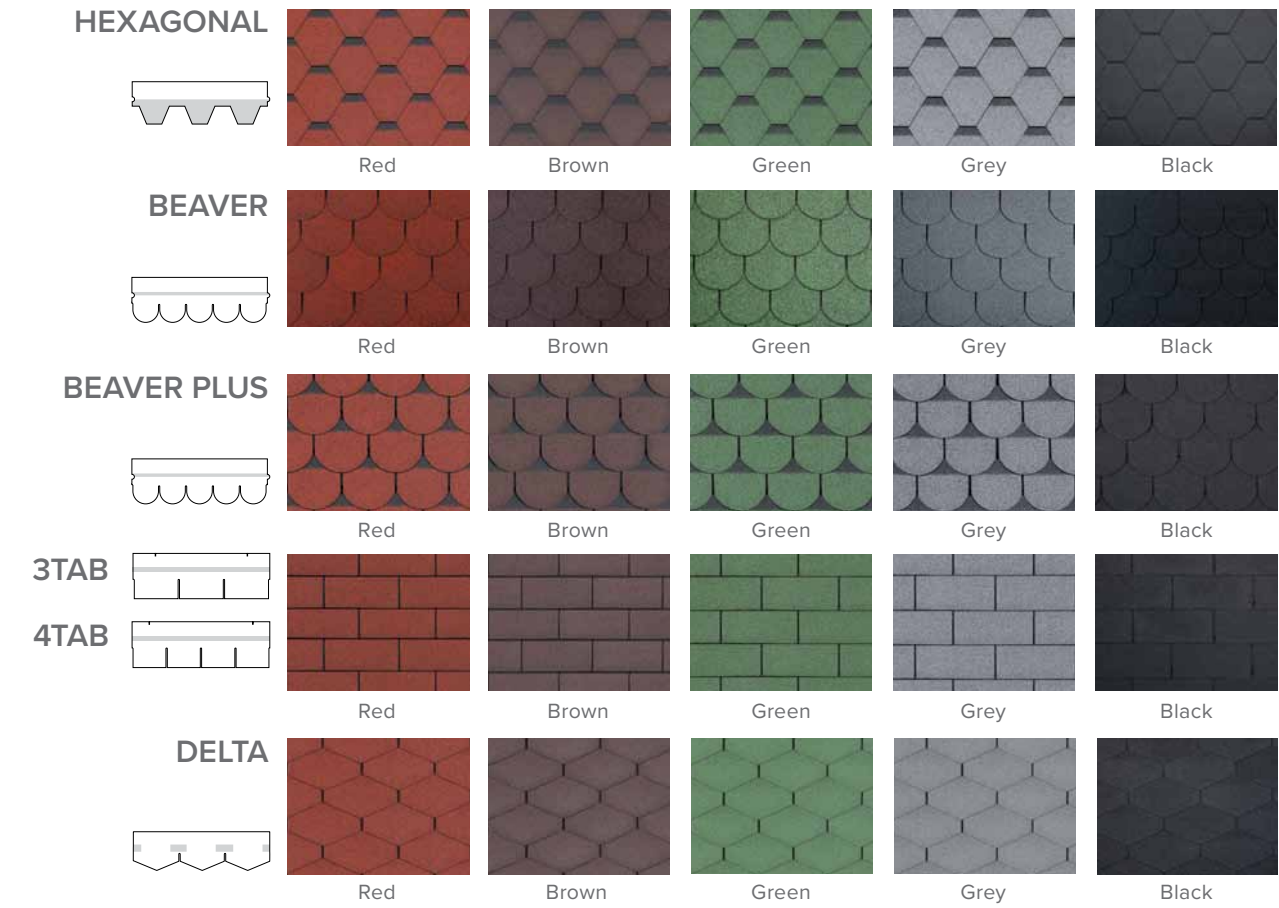

STANDARD ROCK series ETA 12/0264

Standard Rock series – economical choice with assured quality and reliability.

10 YEARS
MANUFACTURER'S WARRANTY



Types of adhesive systems of shingles

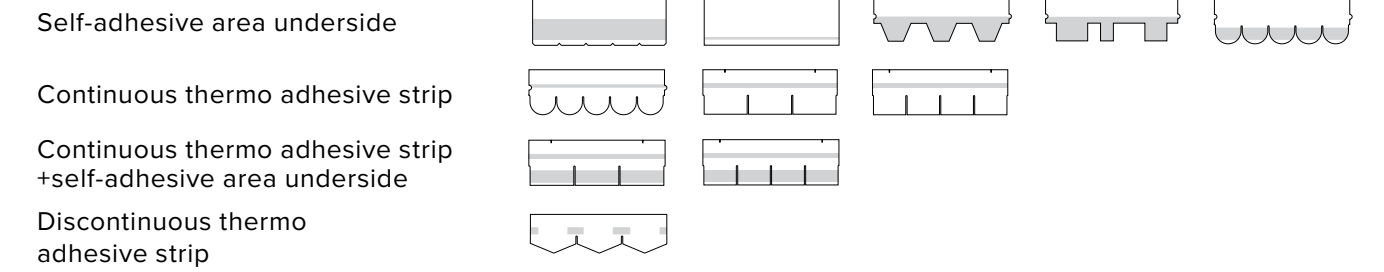

Accessories

| | |
|--|--|
| <p>TECHNONICOL hip & ridge & starter shingles</p>  <p>Hip & ridge & starter shingles produced with SBS modified asphalt are extremely flexible; they are used for quick and easy installation of a starter row along eaves. These pre-cut shingles can be separated into three smaller pieces for further application on hips and ridges to add the perfect aesthetic finish to your roof. Maximum protection against wind, snow and rain is provided. Available in a wide range of colors to match any chosen roofing color solution. Dimensions: 1 m x 0,25 m. Coverage per a bundle: 12 lin. m (hips & ridge) and 20 lin. m (starter strip). Color: </p> | <p>Valley roll material MIDA UNIFLEKS EKM</p>  <p>Used as waterproofing underlayment in roof valleys which are prone to leakages under snow and rain loads and thus require extra protection. This material is also used to seal joints between roofing and piping or vertical walls. Dimensions: 1 m x 10 m. Color: </p> |
| <p>Mastic TECHNICONOL No. 23</p>  <p>Provide extra adhesion of roofing shingles and other bitumen-based materials to such surfaces as brick, concrete, metal, wood, ceramic etc. Operating temperature ranges from -5°C upto +40°C.</p> | <p>Roofing nails TECHNICONOL</p>  <p>Anticorrosive roofing nails with circular cross-section for fastening of asphalt shingles to a wooden deck. Also used for mechanical fastening of roof components. Head diameter ≥ 9 mm, shank length – 30 mm, 45 mm.</p> |
| <p>Ridge ventilation</p>  <p>Necessary for pitched roofs to provide removal of excess moisture out of roofing system. Hip & ridge shingles matching a basic roof color are installed over a ridge vent to make it unnoticeable and to give a finishing touch to complete the look of your roof. Rate of flow: 1 vent covers ~ 20–25 m². Dimensions: 0,61 m x 0,29 m.</p> | <p>Ventilation outlet D110</p>  <p>It is used to ventilate the sewer system and to remove all odors and vapors generated by food preparation. We recommend that you use it on the roofs of summer houses. Dimensions: D_{of the outlet} is 110 mm. H_{of the pipe} is 500 mm. Color: </p> |
| <p>KTV ventilation component</p>  <p>Used for complicated roof designs as extra ventilation components to remove excess moisture out of roofing system. Rate of flow: 1 ventilation unit covers ~ 5–10 m². Dimensions: D_{of the outlet} is 110 mm. Color: </p> | <p>Insulated ventilation outlet, D125/160</p>  <p>It is used to ventilate the sewer system and to remove all odors and vapors generated by food preparation. We recommend that you install it on the roofs of structures with year-round occupancy. It is not subject to icing even during prolonged frost. Dimensions: D_{of the pipe} is 125 mm. D_{of the pipe (external)} is 160 mm. H_{of the pipe} is 500 mm. Color: </p> |
| <p>Ventilation component PILOT</p>  <p>It is used to remove excess subroof moisture on roofs that are not ridged. It is fixed to the roof under the shingles at the moment of their installation. Rate of flow: 1 ventilation unit covers ~ 5–10 m². Dimensions: D_{of the outlet} is 110 mm.</p> | <p>Self-adhesive sealing band NICOBAND</p>  <p>NICOBAND is a universal self-adhesive sealing band. The material is easy and convenient to use, and it bonds ideally to concrete, plaster, metal, bitumen, stone, wood and other surfaces. The sealing band is designed for sealing seams and joints, repairing cracks, waterproofing, and corrosion protection. Color: </p> |